



Tel	/	561.277.9751
Email	/	info@3bprotection.com
Web	/	www.3bprotection.com
Inquiries	/	estimating@3bprotection.com
Addr	/	364 Cypress Drive, Suite 102, Tequesta, FL 33469

3B FORTIFLOW™

The 3B FortiFlow™ Product Family delivers next-generation ballistic, blast, and forced-entry protection while enabling controlled airflow and ventilation. Engineered under the 3B Real-Life Situation (RLS) testing standard, each system integrates advanced louver technology with structural defense, ensuring that critical infrastructure, industrial sites, and secure facilities can breathe safely without compromising security. FortiFlow™ systems are available for integration into walls, gates, and doors.

Designed for heavy industrial and high-heat environments, FortiFlow™ systems provide scalable solutions for substations, power generation sites, turbine enclosures, data centers, and other facilities where continuous ventilation and high-level protection must work hand in hand.

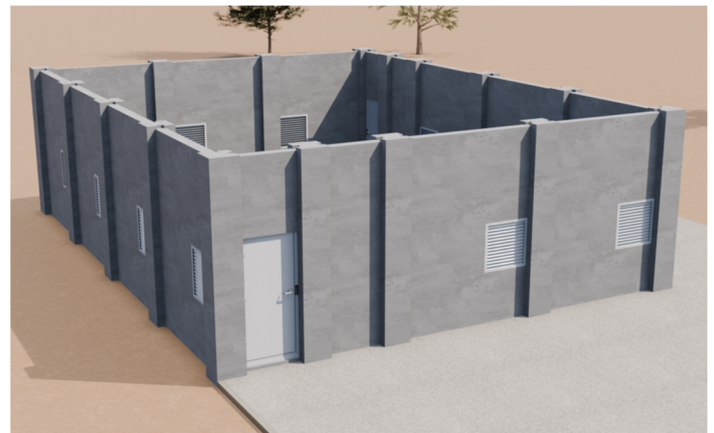
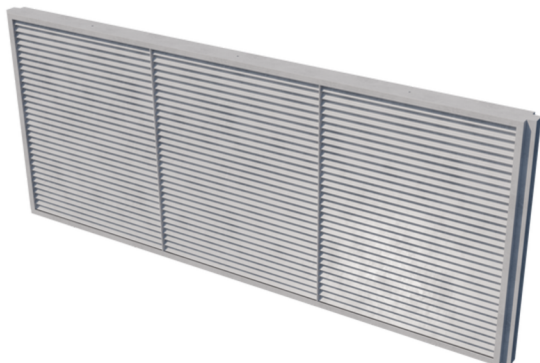
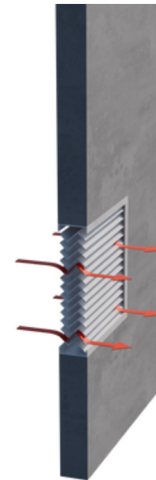



KEY FEATURES:

- **UL Levels 3-8 Rating:** As a UL 752 Levels 3-8 rated louver system, this product is engineered to withstand multiple ballistic threats ranging from common handguns to rifles and submachine guns. It provides dependable protection for ventilated openings in facilities that require both continuous airflow and a high level of ballistic resistance across a broad threat spectrum.

PRODUCT FAMILY:

- **FortiFlow-25™ — Partial-Flow Defense:** FortiFlow-25™ combines solid ballistic panels with engineered louver modules to provide approximately 25% airflow. Ideal for sites requiring high ballistic and blast protection with limited ventilation—such as substations, control yards, or critical perimeter zones—this design delivers maximum structural strength while enabling essential thermal relief and air circulation.
- **FortiFlow-50™ — Balanced Performance:** FortiFlow-50™ provides an optimized 50/50 ratio between louvered and solid protection zones. Engineered for facilities where cooling and protection are equally critical—power plants, data centers, and industrial enclosures—the system delivers stable pressure control, effective cooling, and full ballistic, blast, and forced-entry resistance.
- **FortiFlow-100™ — Full-Flow Armor:** FortiFlow-100™ is a fully ventilated ballistic and blast-resistant wall system that maximizes airflow without sacrificing strength. Designed for extreme heat or high-output equipment environments, it provides full-scale ventilation while maintaining complete perimeter protection against ballistic and forced-entry threats.
- **FortiFlow-G25™, G50™, G100™ — Heavy-Duty Access Gates:** The FortiFlow™ Gate series maintains the same ballistic, blast, and forced-entry protection as the adjoining wall system while enabling vehicle and equipment access. Each gate uses reinforced hinge assemblies and matching louver patterns for airflow continuity and visual alignment. Available in swing or sliding configurations; manual or automated.
- **FortiFlow-D25™, D50™, D100™ — Secure Personnel Doors:** The FortiFlow™ Door series provides secure personnel or service access within any FortiFlow™ perimeter. Built with the same ballistic and blast-rated materials as the wall system, each door features precision-fitted frames, multi-point locking, and optional access-control integration. Louver configurations align with the selected wall ratio to maintain uniform airflow and architecture.

APPLICATIONS:

- Power Generation and Energy Facilities
- Electrical Substations and Utility Infrastructure
- Industrial and Manufacturing Plants
- Data Centers and Mission-Critical Facilities
- Secure Government and Municipal Facilities
- High-Heat and Heavy Industrial Environments

